

Subconstruction for Insulation Cladding

WUS-50

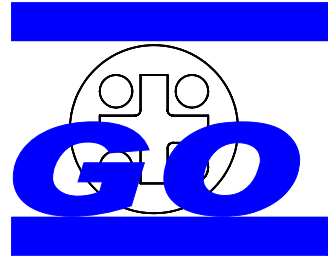

Application

3-part subconstruction set for preparation of industrial insulation cladding on tanks, filters, furnaces, tubes and chimneys.
Applicable to fix- and loose-points.
Anchor extensions in mm-grid.
Outstanding heat- and sound damping properties.

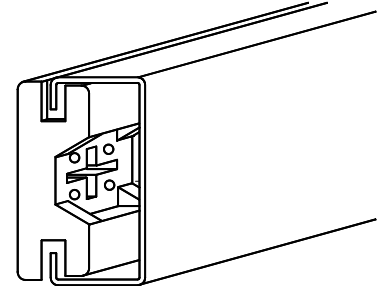
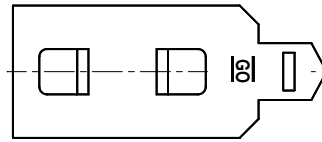

Assembly Process

1. Weld or screw the anchor on the object
2. Mineral wool mats are simply skewered onto the anchors
3. Insert the coupling units
4. Attach C-rails onto the anchors

- * Pressure load up to 2000 N
- * Tractive load up to 2000 N
- * Vertical load up to 2000 N

Materials

- * Anchor head: DX51D+Z150NAC (mild steel)
- * Extensions: S235JRG (mild), DX51D+Z150, 1.5415 (16Mo3) & 1.4512
- * Coupling unit: AL235D with elastomer dumper (EPDM)
- * C-Rail: DX51D+Z150MA

Sound damping see Brunel Survey

Coupling Unit

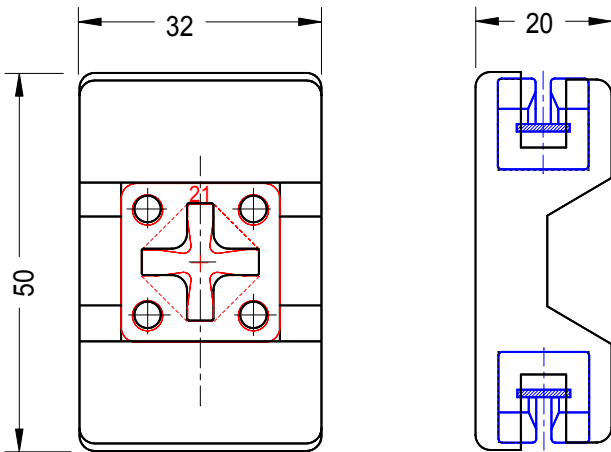

C-Rail

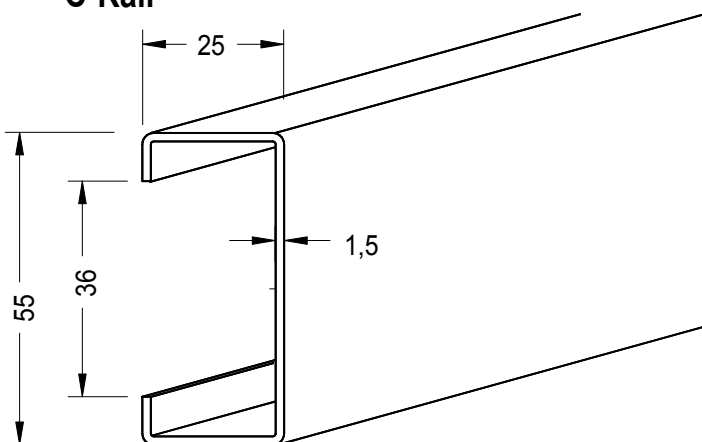

Anchor Head

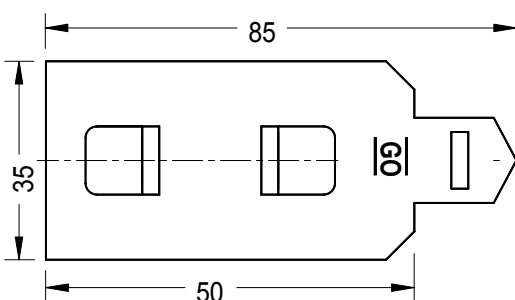

Coupling Unit

Type	Load: Pressure daN	Tractive daN	Vertical daN
WUS-50	200	200	200

C-Rail

Type	A mm	B mm	C mm	Thickness mm	Length mm
CP-55-1,5	25	55	36	1,5	6000

Anchor Heads

Typ	L mm	L1 mm	B mm	Thickness mm
WDA-85	85	50	35	3

Anchor Extensions with thermal separation, 1,5 mm, asbestos-free

Profile mm	Material			
35 x 3	S 235 JR G2	DX51D+Z150	1.5415	1.4512
40 x 4	S 235 JR G2	DX51D+Z150	1.5415	
8 x 55 x 8 x 3	S 235 JR G2	DX51D+Z150		