

Subconstruction for Insulation Cladding

DUK-50

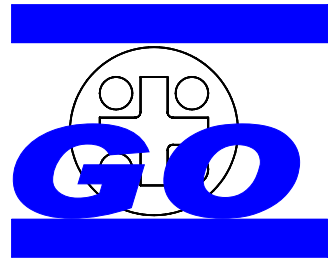

Application

3-part subconstruction set for preparation of industrial insulation cladding on tanks, filters, furnaces, tubes and chimneys.
Applicable to fix- and loose-points.
Anchor extensions in mm-grid.

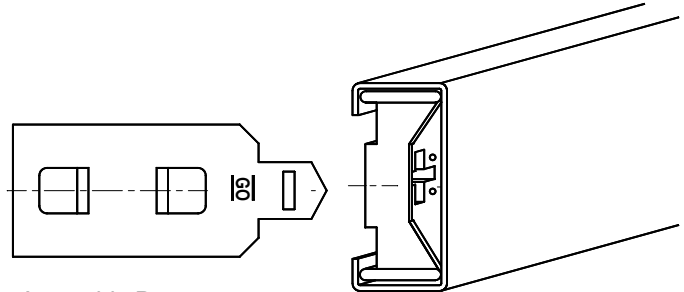

Assembly Process

1. Weld or screw the anchor on the object
2. Mineral wool mats are simply skewered onto the anchors
3. Insert the coupling units
4. Attach C-rails onto the anchors

- * Pressure load up to 3000 N
- * Tractive load up to 3000 N
- * Vertical load up to 3000 N

Materials

- * Anchor head: DX51D+Z150NAC (mild steel)
- * Extensions: S235JRG (mild), DX51D+Z150, 1.5415 (16Mo3) & 1.4512
- * Coupling unit: AL235D
- * C-Rail: DX51D+Z150MA

Coupling Unit

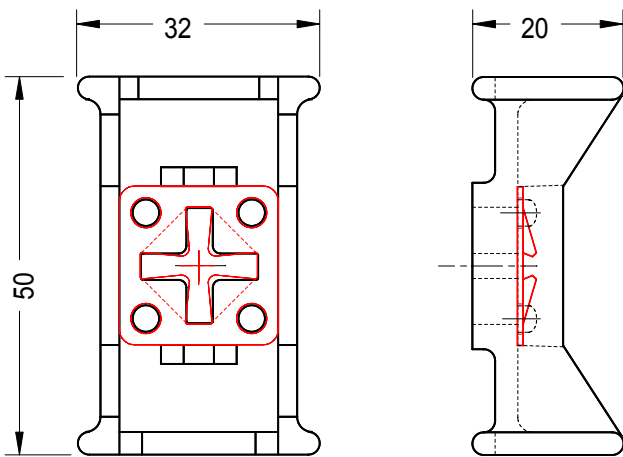

Coupling Unit

Type	Load: Pressure daN	Tractive daN	Vertical daN
DUK-50	300	300	300

C-Rail

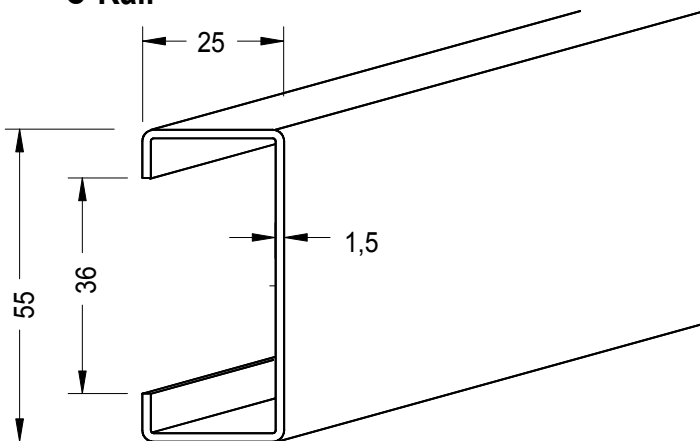

C-Rail

Type	A mm	B mm	C mm	Thickness mm	Length mm
CP-55-1,5	25	55	36	1,5	6000

Anchor Head

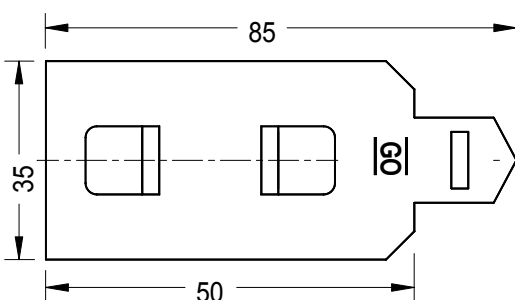

Anchor Heads

Typ	L mm	L1 mm	B mm	Thickness mm
WDA-85	85	50	35	3

Anchor Extensions with thermal separation, 1,5 mm, asbestos-free

Profile mm	Material			
35 x 3	S 235 JR G2	DX51D+Z150	1.5415	1.4512
40 x 4	S 235 JR G2	DX51D+Z150	1.5415	
8 x 55 x 8 x 3	S 235 JR G2	DX51D+Z150		